

Strip Light Instruction

Brief Introduction

COB(chip on board) strips are made with flip-chips on PCB, unlike traditional LED strips are made with SMD on PCB. Because of the mini size of chips, we could put a lot chips on PCB, like 528 chips or 320 chips on single meter PCB, the distance between each chips are very close which make the light is very uniform and evenly, the biggest advantage is that it's spots free without the cover.

Wiring Diagram

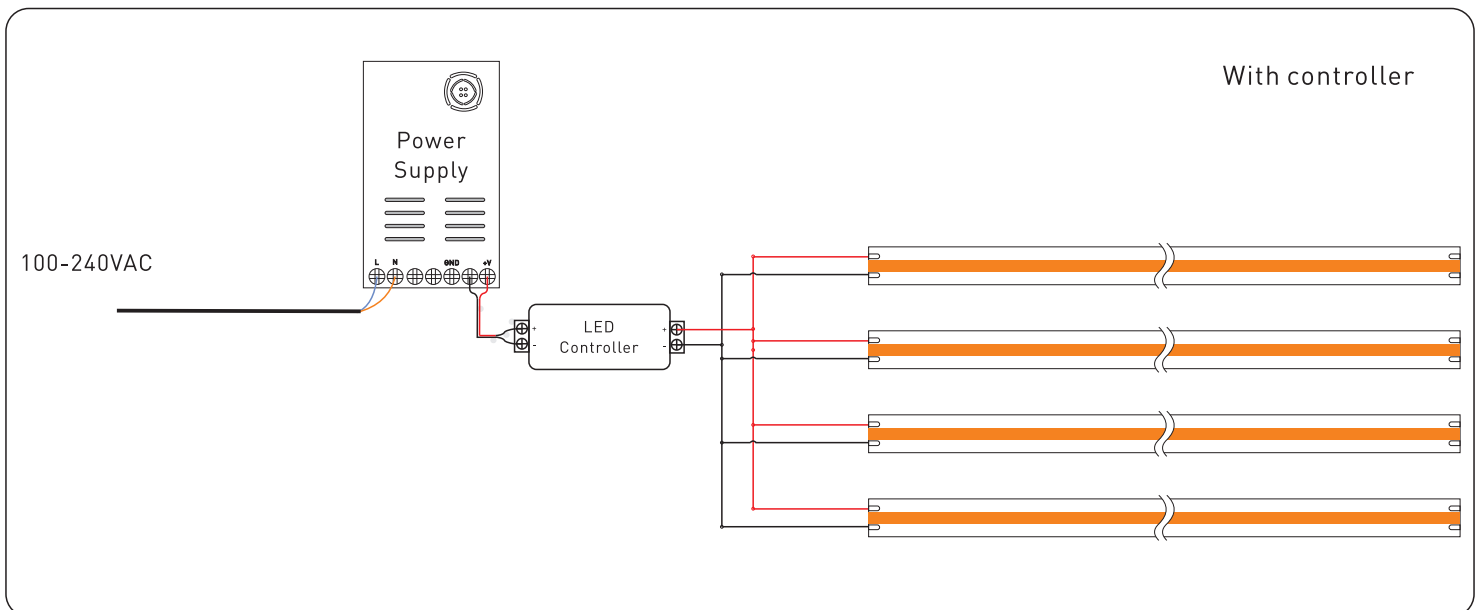
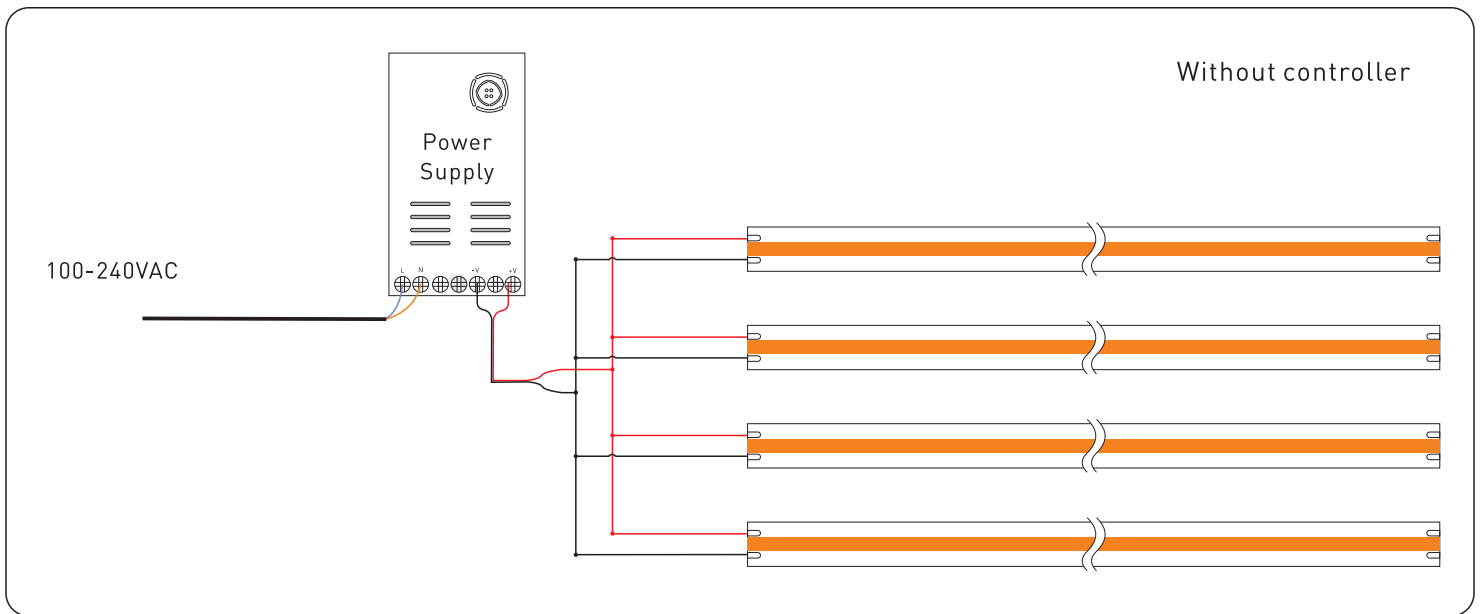

Installation

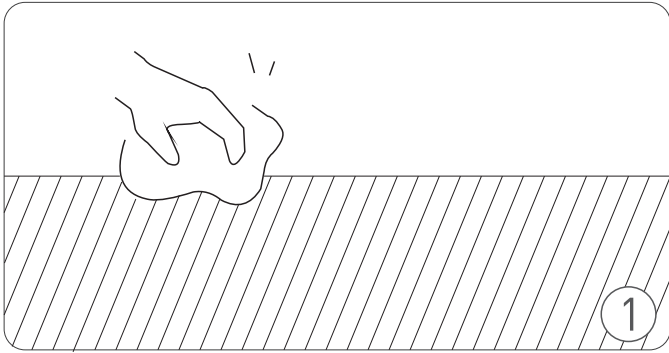

Clean the surface to make sure the surface free from grease, dust and liquid.

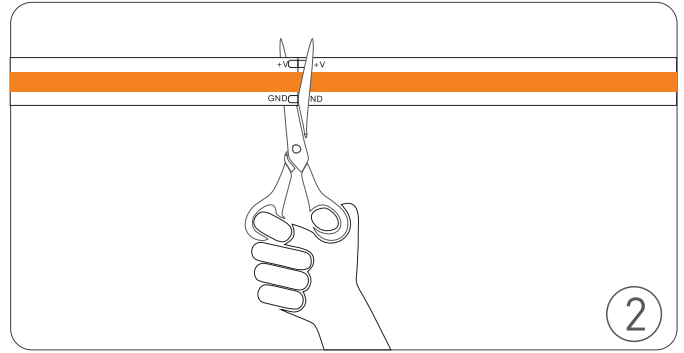

measure the length of the surface, cut the COB strip need, please cut the COB strip according to the markings on the COB strip.

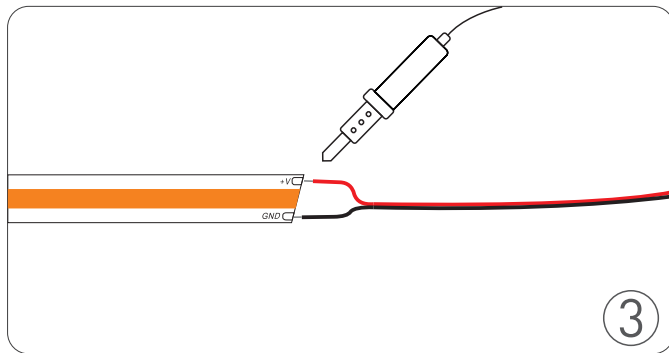

Soldering wires to the cutting place if needed, please match the colors of the wires to the polarities rightly.

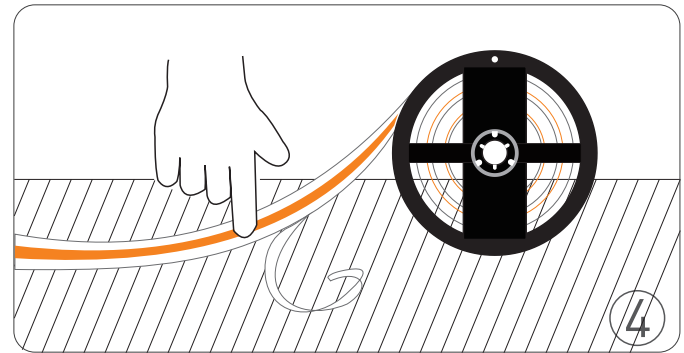

Tear the double sided adhesive tape and paste the COB strip to the surface, press the COB strip to stick to the surface tightly.

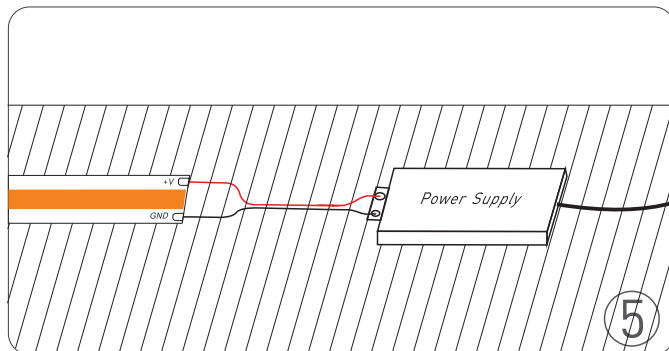

Without controller, connect the COB strip to the power supply directly, then complete installation.

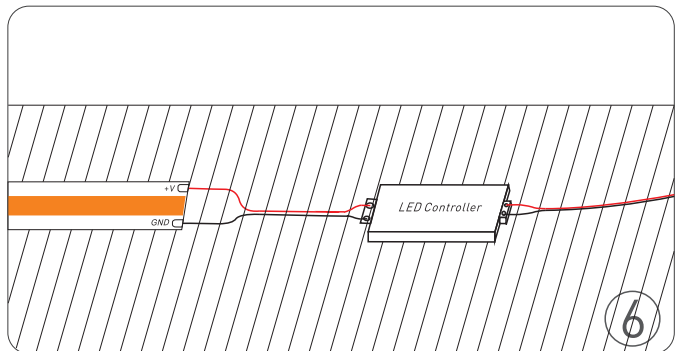

With controller: connect the COB strip to the LED controller firstly.

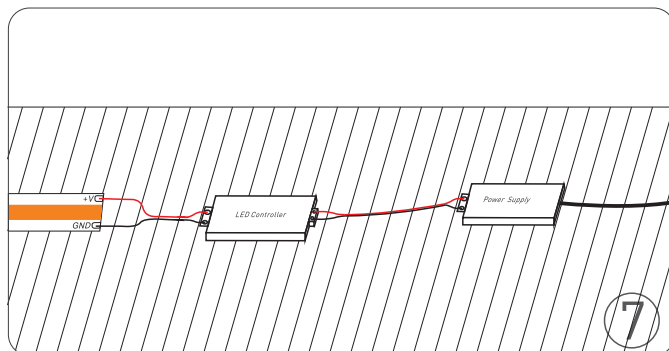

With Controller: connect the LED driver to the power supply secondly, then complete installation.

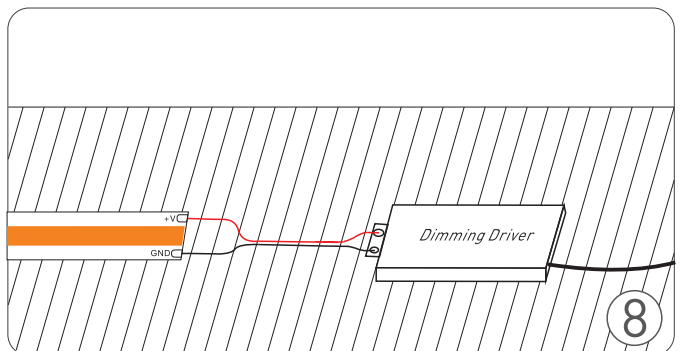

With dimming driver: connect the COB strip to the dimming driver firstly.

Warnings

1. Do not use underwater.
2. Disconnect the power source before installation.
3. The operating temperature is -10°C to $+40^{\circ}\text{C}$, please make sure the installation surface should be less than $+40^{\circ}\text{C}$.
4. Do not install the products close to flammable materials.
5. Normally the output efficiency of power supply is between 80%~95%, to avoid overload during installation, please make sure the total outputs of the COB strip lights should be less than 80% output watts of the power supply.
6. For better color and brightness consistency between the beginning and ending, we set up max installation length for each COB strip. The max installation length is a balance of long running and brightness consistency. To install COB strip over the max installation length, please connect them in parallel or powering on double sides.
7. Do not power on while COB strip are rolled, or it will overheat and damaged.
8. Do not power the COB strip by other power source, like 100~120Vac, 200-240Vac etc.
9. Keep all components from children.