

## RGBW LED Wall Plate Controller Dimmer Switch T24 LED 4 zone12/24V - Battery Operated Remote Controller - up to 30m range 4 Zone

**£43.20**

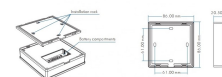

Mechanical Structures and Installations



Installation diagram

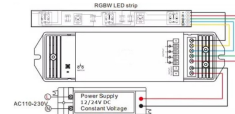
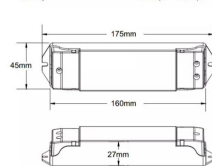
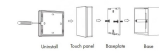

### PRODUCT INFORMATION

Warranty	1 Year Warranty
Part L Compliant	No
Dimensions	Remote - 122mm x 53mm x 17.5mm Receiver - 97mm x 33mm x 18mm
Weight	0.18kg

### TECHNICAL SPECIFICATIONS

Input Voltage	12/24V DC
Operating Temperature	-20°C to 50°C
Ingress Protection	IP21
Output Voltage	Single zone only 12/24V DC - 4 Channel / 5A per Channel

### AVAILABLE OPTIONS

3-Hour Emergency Version No	
1-10V Dimmable	No
DALI Dimmable	No

4 Zone 12/24V RGBW RF REMOTE Controller for LED flexible strip - note unit is RF hence doesn't require a direct line of sight and battery operated so doesn't need hardwiring. Control colour with colour-selection plate multi-mode for colour changing effects, 0 to 100% brightness. 4 Channel (5A per channel) - hence suitable for loads of 240W @ 12V / 480W @ 24V Max. For larger projects, please refer to our data repeater/power amplifier range along with this product. Requires 2 x AAA batteries (not-included)

[DOWNLOAD TYPICAL LED STRIP / LED TAPE WIRING DIAGRAM](#)

[DOWNLOAD RF REMOTE CONTROL PRODUCT INSTALLATION MANUAL / GUIDE](#)

[DOWNLOAD LED RF RECEIVER PRODUCT INSTALLATION MANUAL / GUIDE](#)

[DOWNLOAD DATA REPEATER / POWER AMPLIFIER PRODUCT INSTALLATION MANUAL / GUIDE](#)